

VEB-S - KK - KE

Ventilation valves

Product	VEB-S	KK	KE
Function	Exhaust	Exhaust	Supply
Construction material	Polypropylene	Steel	Steel
Finishing	Anti-static white	RAL 9010	RAL 9010

IT - KK - KE exhaust valves are suitable for ventilation in closed rooms with odor or stale air build-up. They are very efficient and functional. These valves carry out two different functions:

- EXHAUST of stale air, series IT - KK
- SUPPLY of outdoor ventilation air, series KE

The valves are fitted with an adjustable core that allows a precise control of the exhaust

or supply flow volume. The aerodynamic shape of the valves and the disk allows to maintain the pressure loss and the sound level at a very low level with respect to the flow volume.

Construction IT series: manufactured from anti-static white polypropylene, providing very high resistance against atmospheric and most of the acids.

KK - KE series: manufactured from steel

sheet, finishing in epoxy white coating (RAL 9010).

Applications These valves can be installed in bathrooms and all bordering rooms.

Installation The valves are installed by screwing the valves into the suitable connector. Installation requires only very few simple operations.

Quick selection

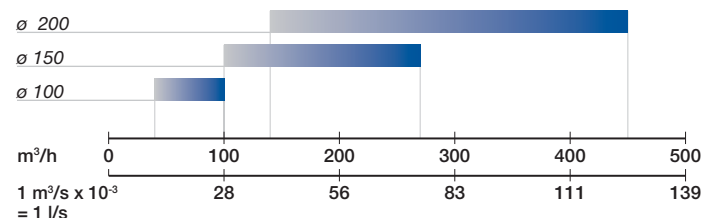

	Q min.	Q max
NR	< 20	< 30
Pressure drop Pa	10	< 100

Size

Type VEB-S

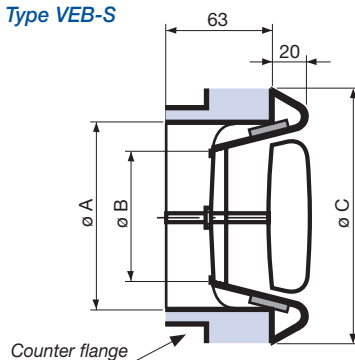

Model	Sizes (mm)		
	ø A	ø B	ø C
VEB-S 100	100	70	145
160	160	115	195
200	200	172	240

Type KK

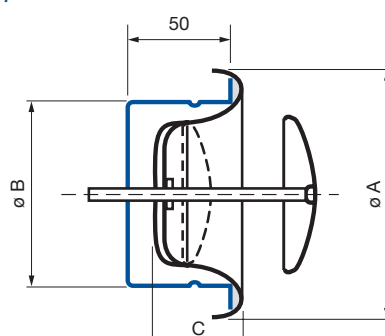

Model	Sizes (mm)		
	ø A	ø B	C
KK 100	138	99	40
150	202	149	50
200	248	199	63

Type KE

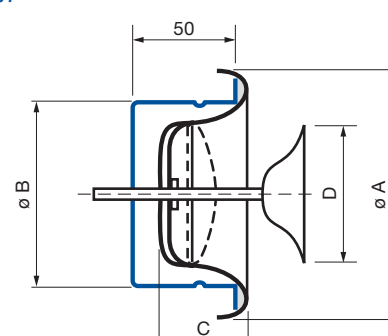

Model	Sizes (mm)			
	ø A	ø B	C	D
KE 100	138	99	40	92
150	202	149	50	235
200	248	199	63	194