

IQTA

Corner chilled beam

Product	IQTA
Construction material	Steel
Finishing	RAL 9010

The chilled beam is suitable for exposed installation along the walls in 367 mm ceiling modules. The chilled beam is equipped with adjusting rails for the adjustment of air flow. 18+18 possible calibration positions, 3 possible air flow directions, two or one way or with different air percentages between the supply

vanes. IQTA beams are fitted with a patented sound attenuator to optimize noise performances. The device is positioned by the air supply duct. Bottom plate can be pushed aside to enable adjustment of capacity, as well as servi-

ce and check-up. Made of galvanized sheet steel, RAL 9010 finishing white, air feeding joint \varnothing 125 or 100 mm. Two - or four-tube coil with joints \varnothing 15 mm. The beam is fitted with a pressure outlet accessible from the room, to enable the measurement of the air flow.

Quick selection

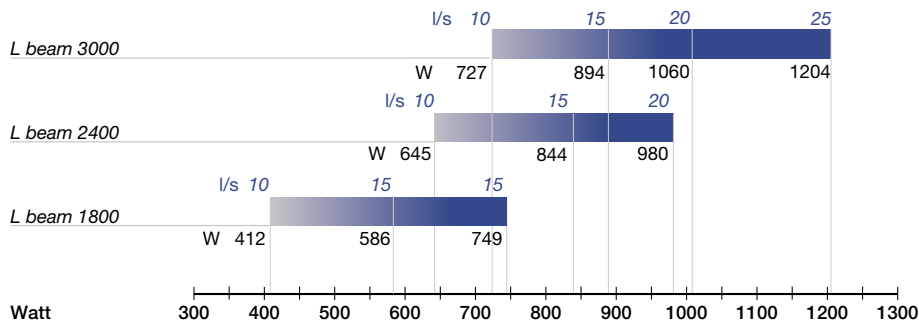

Pressure drop air side	Pa	60
Water capacity	l/s	0,050
Temperature room air	°C	26
Temperature of supply air	°C	16
temperature inlet water	°C	15

The above graphic representation refers to the following operating conditions.

Other conditions can be verified by using the WinDon[®] calculation program. For more information contact our Technical Office, Conditioning Division.

Size

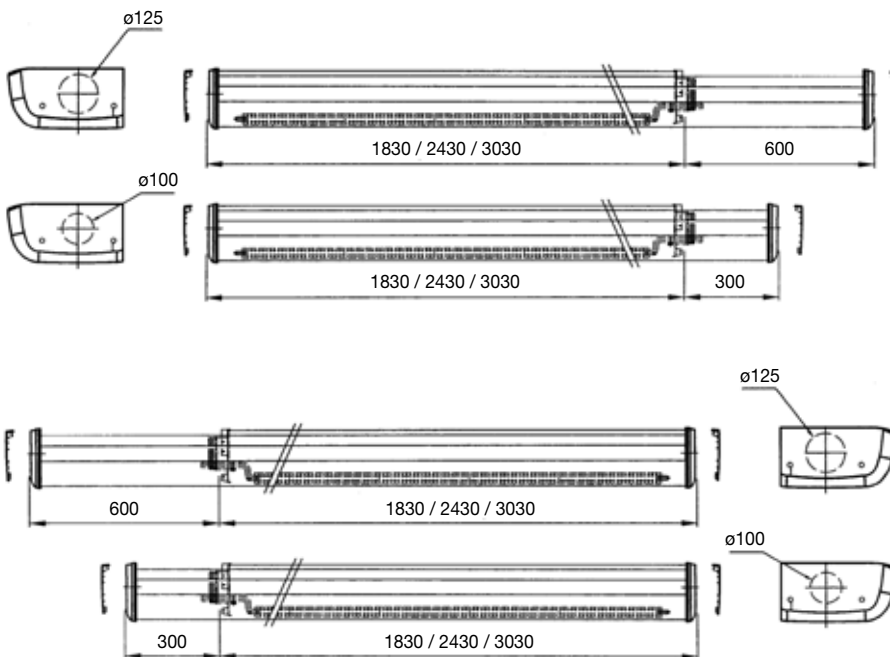

Size	Length
180	1830
240	2430
300	3030

Water volume cooling	0,50 l/m coil
Water volume heating	0,25 l/m coil

IQTA

corner chilled beam

Installation

Flexible hoses are used to make all air connections. We recommend mounting an iris damper to control the air flow. We recommend using fast-connection flexible hoses for the hydraulic connections

to prevent the transmission of vibrations coming from the hydraulic circuit to the chilled beam. This will avoid tension on the connections since they are not static connections and it will mean saving in labor.

This is the standard installation.

For information on other installation methods, please contact our Technical Office, Conditioning Division.

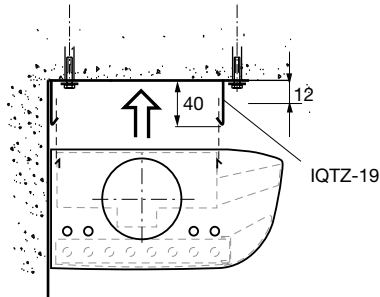

How to order - Main code

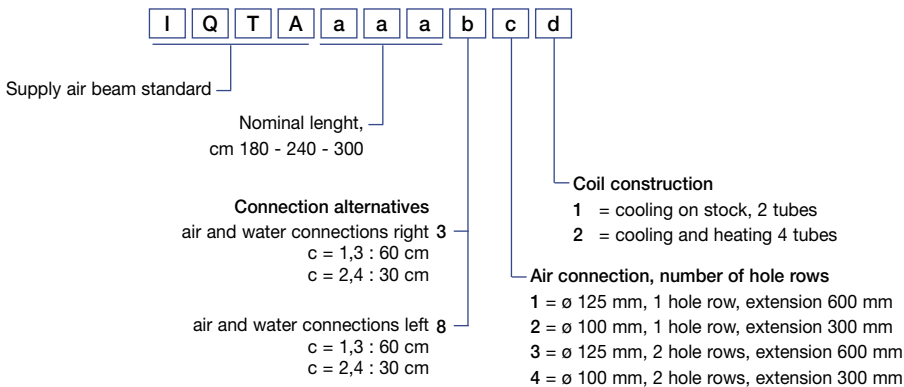

Accessories

QFAZ - 19
Attachment, unpainted
Set with 2 pcs 1 QFAZ-19 per beam

IQAZ - 09 - aaa
Length 050 = 30 - 50 cm
 090 = 50 - 90 cm
 170 = 90 - 170 cm

Enclosure without end walls
Between beam and wall attachments are included

How to order - Accessory code

