



RT 500

Adjustable linear diffusers

Product	RT 500
Construction material	Aluminium
Finishing	Natural anodized

RT 500 linear diffusers are suitable for the intake and outtake of hot and cold air in offices, shops, meetings rooms, etc. These diffusers are particularly suitable for installation in false ceilings and come with 1 or 2 slots.

Every slot has special cylindrical deflectors that can be individually adjusted. These specially-made devices assure an optimal and steady air flow and are very silent.

They also assure a high induction ratio and the penetration of the air flow in the room avoiding a turbulent flow. The diffusers are available in different lengths in order to make them suitable for any type of false ceiling.

Sizes L (mm)

600 800 1000 1200 1500 1800 2000

RT 501 with 1 slot

RT/W 501 supply diffuser	RT/W 501 E right/left supply diffuser	RT/W 501 M intermediate supply diffuser	RA 501 exhaust diffuser	RA 501 E right/left exhaust diffuser	RA 501 M intermediate exhaust diffuser
RP 501 plenum	RP 501 L/R right/left plenum	RP 501 G insulated plenum	RP 501 LG/RG right/left insulated plenum	RP 501 M intermediate plenum	RP 501 MG insulated intermediate plenum
RP 511 plenum with damper	RP 511 L/R right/left plenum with damper	RP 511 G insulated plenum with damper	RP 511 LG/RG right/left insulated plenum with damper	RP 511 M intermediate plenum with damper	RP 511 MG insulated intermediate plenum with damper

RT 502 with 2 slots

RT/W 502 diffusore di mandata	RT/W 502 E diffusore di mandata destro / sinistro	RT/W 502 M diffusore di mandata intermedio	RA 502 diffusore di ripresa	RA 502 E diffusore di ripresa destro / sinistro	RA 502 M diffusore di ripresa intermedio
RP 502 plenum	RP 502 L/R plenum destro / sinistro	RP 502 G plenum isolato	RP 502 LG/RG plenum isolato destro / sinistro	RP 502 M plenum intermedio	RP 502 MG plenum intermedio isolato
RP 512 plenum con serranda	RP 512 L/R plenum con serranda destro / sinistro	RP 512 G plenum isolato con serranda	RP 512 LG/RG plenum isolato con serranda destro / sinistro	RP 512 M plenum intermedio con serranda	RP 512 MG12 plenum intermedio isolato con serranda

Quick selection per linear m.

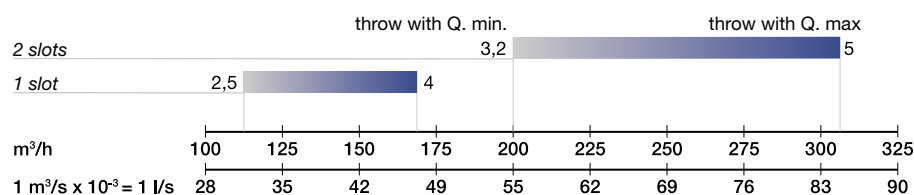

	Q min.	Q max
NR	< 20	< 35
Pressure drop Pa 1 slot.	12	< 29
Perdita drop Pa 2 slot.	10	< 23

RT 500

adjustable linear diffusers

Technical data

- Front width 50 mm with 1 slot, available with standard profile (total width 50 mm) or with shorter profile (overall width 35 mm)
- Available lengths from 300 to 2000 mm in just one element. Other lengths available with 1500 mm central element joined to end parts through connection pin
- False diffusers with back part closed
- Exhaust: without deflectors
- Supply: horizontal flow with one or two way air distribution or alternating distribution through adjustable deflectors that can be calibrated on site or in the factory.
- Length of the cylindrical deflector = 150 mm
- Assembly height between 2.6 and 4 meters
- Available with plenum:
 - with or without air flow adjustment damper on side connection, adjustable from the room
 - up to a length of 1600 mm with round connection, besides 1600 mm with 2 round connections
 - optional internal insulation

Adjustments

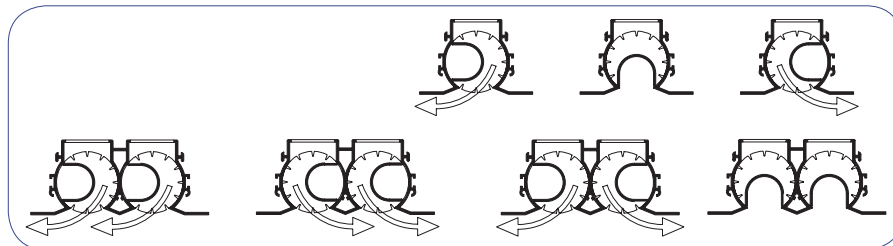

Alternating horizontal throw

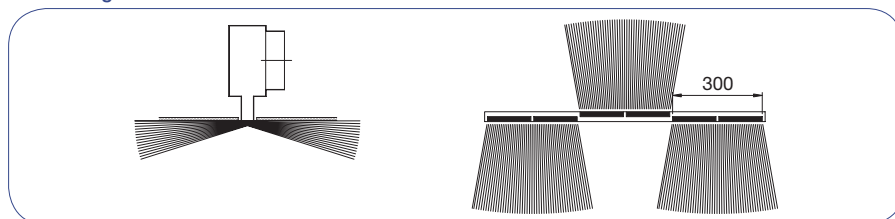

Alternating variable throw

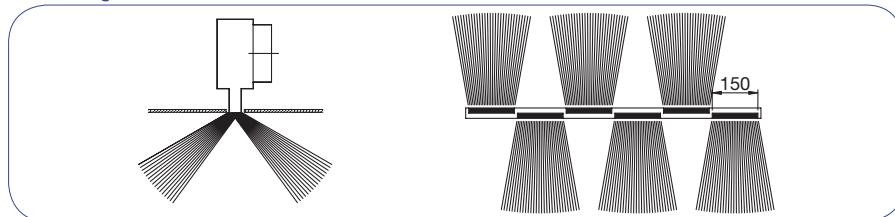

RT 501

L = Length a slot
L₂ and B = Ceiling opening

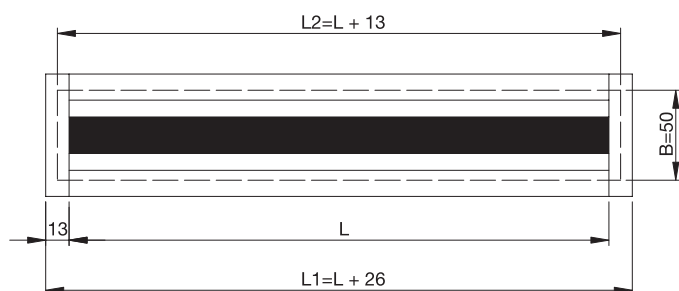

RT 502

L = Length a slot
L₂ and B = Ceiling opening

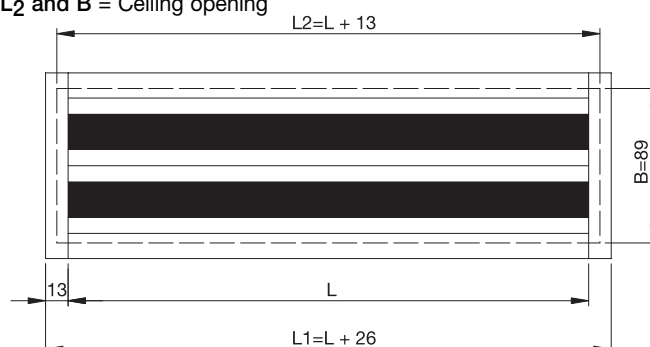

RT 500

adjustable linear diffusers

Accessories

Plenum RP

Galvanized steel sheet distribution box, with 4 fixing brackets. Class 1 insulated type available on request.

RT 501 + RP 501

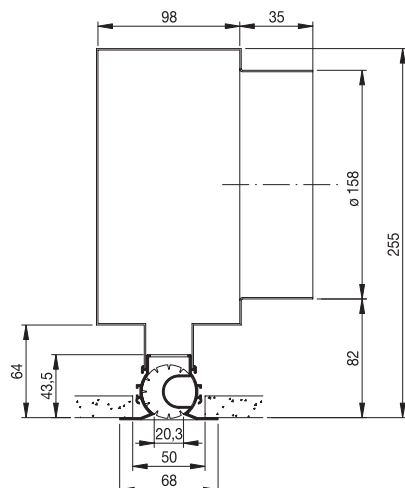

RT 502 + RP 502

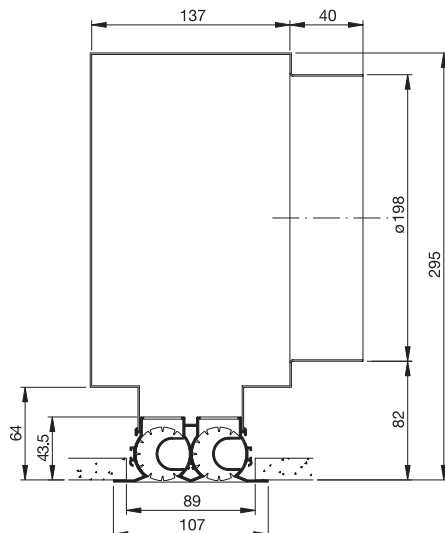

How to order

RT151 with 1 slot, RAL finishing, length of slot 1500 mm

R T 5 0 1 - F 1 5 0 0 - - - - -

How to order

- Anodized aluminium
- F RAL finishing
- Linear diffuser in just one element with end closures on both sides
- E Component to put on ends with final closure
- M Intermediate component without end piece closure
- 501 Ceiling opening 50 mm, 1 slot
- 502 Ceiling opening 89 mm, 2 slots
- T Supply (black deflectors)
- W Exhaust (white deflectors)
- A Exhaust (without deflectors)

How to order

R P 5 0 1 - G 1 5 0 0 - - - - -

- Length of slot (mm)
- Non-insulated plenum
- G Insulated plenum
- Just one component
- L Component to put on outer left end
- R Component to put on outer right end
- M Intermediate component
- 1 One slot
- 2 Two slots
- 0 without adjustment damper on connection
- 1 with adjustment damper on connection
- RP 3 Plenum (assembled directly on diffuser)