



## LD 600

### Linear diffusers

Product	LD 600
Construction material	Aluminium
Finishing	Natural anodized

LD, LA, LF linear louvred diffusers provide a uniform distribution of the air in big areas, without changing the appearance of the ceiling. They are made in extruded aluminium, anodized with natural satin color. The deflectors and the internal dampers are in black PVC.

These units are fitted with 1 to 6 vanes, each individually adjustable within 180°.

The diffusers meet all air distribution and air flow direction requirements without changing the pressure drop.

The plenum is made of galvanized sheet iron with screw and C shaped bracket connection to the diffuser. Available also in the class 1 internally insulated type, polyethylene lining, thickness 6 mm.

**Applications** LD, LA, and LF diffusers are used in big tertiary rooms: hotel lobbies, open space offices, meeting rooms, show rooms, banks, etc.

They can be installed by great glass surfaces to neutralize heat dispersion or heat returns.

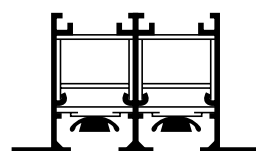

mod. 61..  
Diffuser with deflector

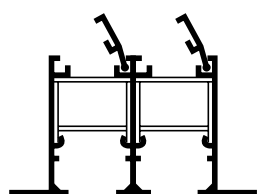

mod. 62..  
Diffuser with damper

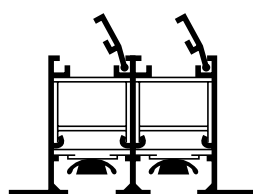

mod. 64..  
Diffuser with damper  
and deflector

Position of deflector

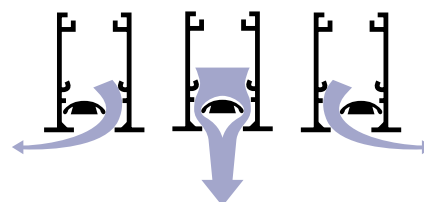

1 SLOT				
LD 611 diffuser with deflector	LD 621 diffuser with damper	LD 641 diffuser with deflec.+damp.	LP 101 plenum	LP 101 / I insulated plenum
2 SLOTS				
LD 612 diffuser with deflector	LD 622 diffuser with damper	LD 642 diffuser with deflec.+damp.	LP 102 plenum	LP 102 / I insulated plenum
3 SLOTS				
LD 613 diffuser with deflector	LD 623 diffuser with damper	LD 643 diffuser with deflec.+damp.	LP 103 plenum	LP 103 / I insulated plenum
4 SLOTS				
LD 614 diffuser with deflector	LD 624 diffuser with damper	LD 644 diffuser with deflec.+damp.	LP 104 plenum	LP 104 / I insulated plenum

Sizes L (mm)

600 800 1000 1200 1500 1800 2000

Linear louvred face diffusers come in the following versions:

- central (M)
- end piece (E)
- or with both terminals

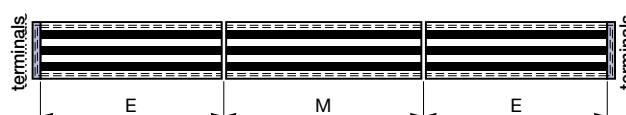

Linear corner module 641 C 642 C 643 C 644 C

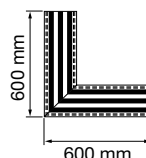

# LD

## linear diffusers

### Quick selection per linear m.

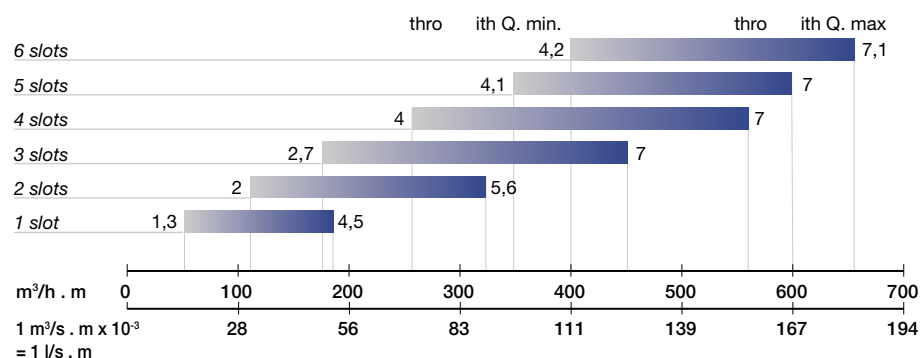

	Q min.	Q max
NR	< 25	< 35
Pressure drop Pa	< 5	< 20

The air flow rates and the pressure drop rates are certified according to the UNI 8728 and prEN 12238 standards, by an independent and certified body, in compliance with the legislation in force on energy saving standards.

### Sizes

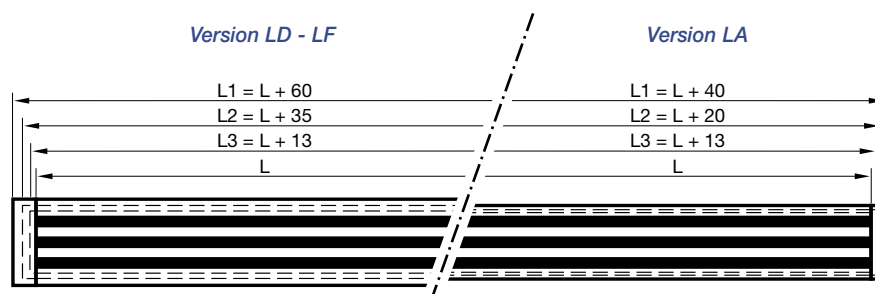
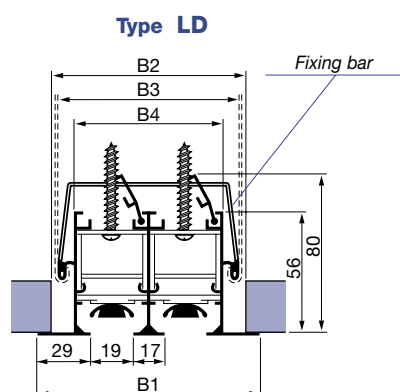

L nominal length (slot length)  
 L1 overall length  
 L2 ceiling opening length  
 L3 duct length

B1 overall width  
 B2 ceiling opening width  
 B3 duct width  
 B4 diffuser width

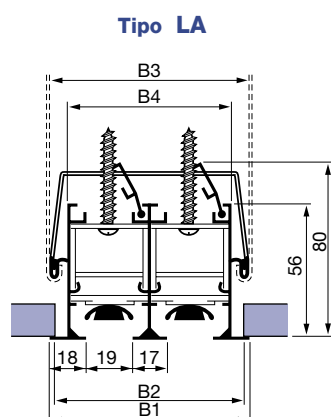

Number of slots	B1		B2			B3		B4
	LD-LF	LA	LD	LA	LF	LD-LF	LA	LD-LF-LA
			Hole size			Inside plenum size		
1	76	56	58	48	43	54	39	38
2	113	93	94	84	80	90	76	75
3	149	129	131	121	116	127	112	111
4	186	166	167	157	153	163	149	148
5	223	203	203	193	190	199	186	185
6	260	240	239	229	227	235	223	222

• Maximum size attainable in just one piece = L 3000 mm  
 (All sizes are in mm.)

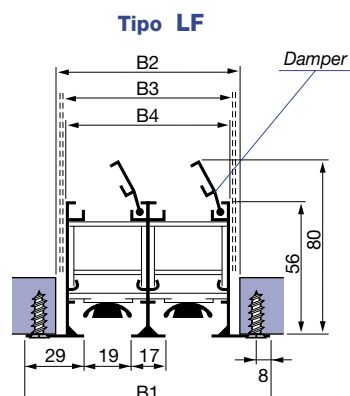

### How to order

L D 6 4 3 E - 1 0 0 0  
 Flange 18 mm, concealed fixing A  
 Flange 29 mm, concealed fixing D  
 Flange 29 mm, fixing with screws F  
 With deflector 1  
 With damper 2  
 With deflector and damper 4  
 Slot length  
 - One piece grille, with terminals  
 E End piece with side terminal  
 M Central piece without terminal  
 C Corner piece  
 Number of slots

## Accessories

### LD linear diffusers

#### LP Plenum

Distribution box in galvanizes steel sheet with screw and C-shaped bracket connection to the diffuser. Available also in the class 1 internally insulated type, polyethylene lining, thickness 6 mm.

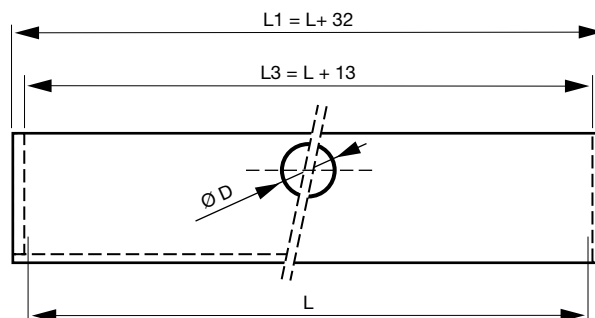

#### Type LP 100

Plenum for diffusers with LD flange or LA with mounting bracket.

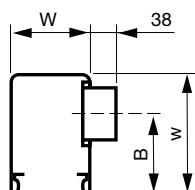

Number  
of slots

Sizes (mm)

	D	B	H	W	W
				LP 100	LP 110
1	125	127	203	56	41
2	160	171	254	92	78
3	200	192	305	129	114
4	200	243	356	165	151
5	200	290	405	201	187
6	225	317	455	238	224

#### Type LP 110

Plenum for diffusers with LF flange

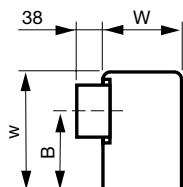

Length of diffuser	Number of round connections included in the plenum
$L \leq 1000$	1
$1000 \div 2000$	2

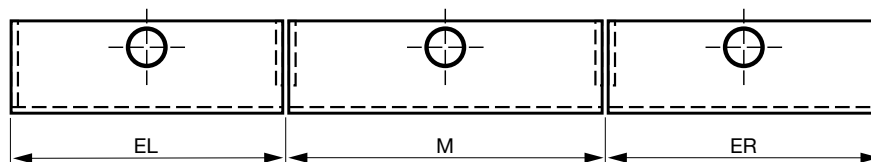

#### Fixing system

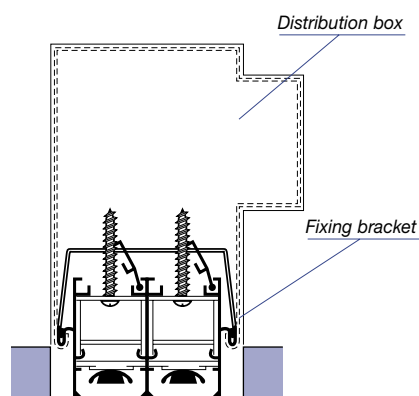

Distribution box available in version::

- central (M)
- end piece (EL or ER)
- or entire section

#### How to order

L	P	1	0	3	I	E	R	-	1	0	0	0
For diffusers LD, LA 0 For diffuser LF 1					-	ER Right end piece EL Left end piece M Central	Nominal length					
Number of slots												
							- Not insulated I With insulation					