



## AD 250 - GF 250

### Exhaust grilles

Product	AD 250	GF 250
Construction material	Aluminium	Steel
Finishing	Natural anodized	RAL 9010

AD 250 and GF 250 exhaust grilles are used in civil and industrial facilities for conditioning, thermal-ventilation and ventilation systems.

AD 250 and GF 250 exhaust grilles are made as follows:

- AD 250: extruded anodized aluminium frame. Fixed vanes, 45° bent.
- GF 250: frame and vanes profiled in steel sheet, stove enameled white RAL 9010

The AD 251 and GF 251 versions come with protection grid, square mesh 12.5 x 12.5 mm.

### Size

#### type AD 250 - GD 250

Fixing with clips and relevant counter-frame

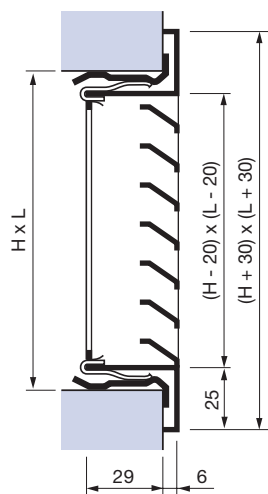

#### type AF 250 - GF 250

Fixing with screws

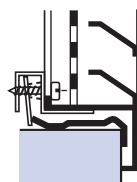
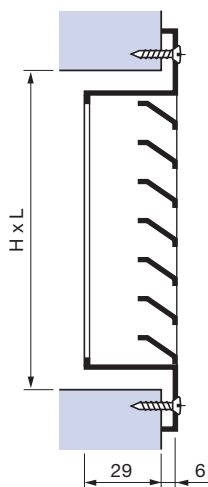

ON REQUEST

#### type AE 251 - GE 251

Fixing with hidden screws and relevant counter-frame

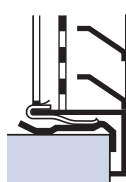

ON REQUEST

#### type AD 251 - GD 251

Fixing with clips and relevant counter-frame

Nominal size (mm)

L	H
200	x 100
300	x 100
400	x 100
500	x 100
300	x 150
400	x 150
500	x 150
600	x 150
200	x 200
300	x 200
400	x 200
500	x 200
600	x 200
800	x 200
1000	x 200
300	x 300
400	x 300
500	x 300
600	x 300
800	x 300
1000	x 300
150	x 400
200	x 400
300	x 400
400	x 400
500	x 400
600	x 400
800	x 400
1000	x 400
150	x 500
200	x 500
300	x 500
400	x 500
500	x 500
600	x 500
800	x 500
1000	x 500
150	x 600
300	x 600
400	x 600
565	x 565
800	x 600
1000	x 600
1200	x 600

Overall dimensions 595 x 595 (suitable for false ceiling installation)

Damper GT 007 maximum possible size in one piece 600X600, other bigger sizes are composed of 2 or more dampers

# AD 250 - GF 250

## exhaust grilles

### Quick selection

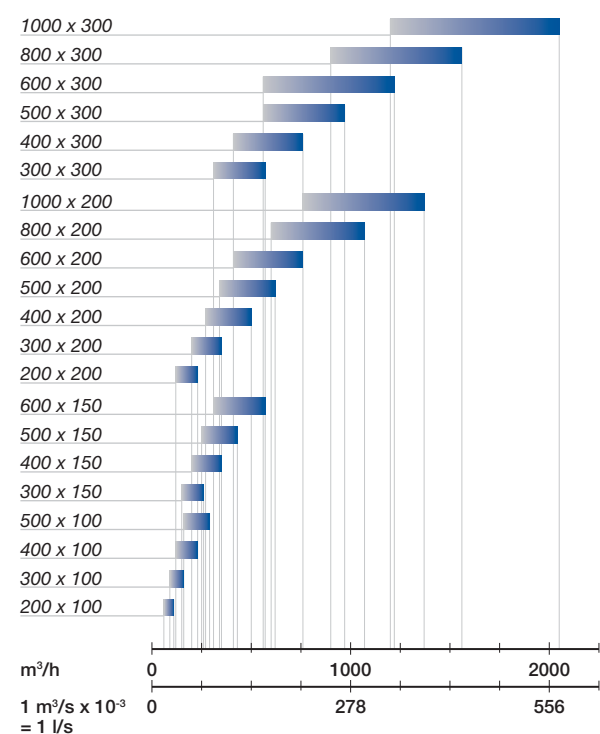
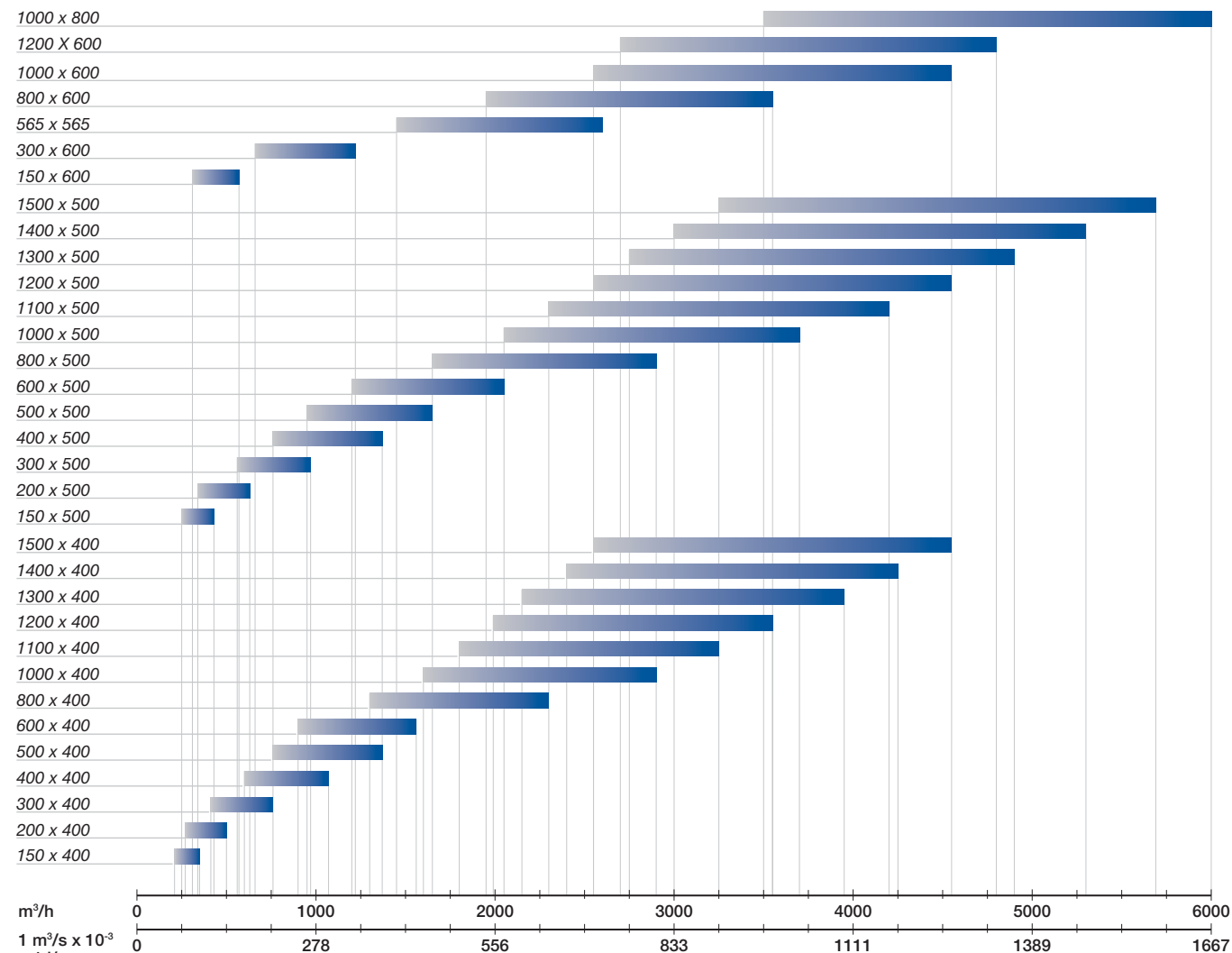

	Q min.	Q max
NR	< 25	< 35
Pressure drop Pa	< 10	< 30

The air flow rates and the pressure drop rates are certified according to the UNI 8728 and prEN 12238 standards, by an independent and certified body, in compliance with the legislation in force on energy saving standards.

### How to order

Anodized aluminium A	A	D	2	5	0	0 Without damper
Enameled steel G						1 With mouse protection grid
RAL 9010						7 With GT 007 damper
Fixing with clips D						
Fixing with hidden screws E						
Fixing with visible screws F						